



## Model 1010

Large Domestic, Light Commercial



## Model 1010

### Extending Meter Life With Proven Accuracy Retention

#### General Details

The Model 1010 is designed for large domestic or light commercial applications. Utilising the compact BK-G6 module it provides a designed capacity of 10 m<sup>3</sup>/h of natural gas at 125 Pa pressure drop (Natural Gas specific gravity 0.62).

#### Construction

The Model 1010 is designed for extreme weather conditions having a fully sealed hydrophilic coated UV stabilised index, die cast aluminium housing which is Alodine surface pre-treated followed by baked Woodland Grey polyester powder coat.

#### Easy Installation

The meters inlet / outlet bosses and external dimensions are identical to that of the Model 750. While delivering an increased flow channel performance via the BK-G6 module the Model 1010 meter weighs just 100 grams (100g) more than the Model 750. This allows domestic gas services to be upgraded to a higher flow capacity without the need to alter the pipe-work at the meter, saving time and money.

#### Product Enhancements

Every Model 1010 gas meter is supplied pulse ready so that the meter can be retrofitted with a pulse output module for advanced metering applications without the need to replace the meter index.

The Model 1010 is also available with a top reading index, allowing ease of reading when the meter is installed at ground level. The model 1010 is also available with Viton o-rings for aggressive gas applications.

#### Accuracy

The outstanding design features of the Model 1010 gas meter such as the tangent control, large cyclic capacity and magnetic drive index provide unparalleled accuracy. Our calibration and test facilities are accredited to ISO/IEC 17025.

#### Accuracy Retention

The initial accuracy of a meter is easy to achieve by using calibration to pass initial testing. However, sustained accuracy over time comes down to the quality, design and construction of the meter. The Model 1010 has been designed for long-term stability and extended field life.

#### Endurance Testing

Endurance testing to the most stringent world requirements has been conducted on the Model 1010 demonstrating long term accuracy retention. The Model 1010 meter exceeds the endurance testing requirements of the European Standard EN1359:1999, American National Standard ANSI B109.1, Australian Gas Association AG702, and OMIL Recommendation 31.



## Model 1010 Specifications\*

### Gases

Natural gas, town gas, propane, butane, LPG and inert gases. For other gases please consult Landis+Gyr.

### Temperature Range

-10 °C to +65 °C.

### Cyclic Capacity

0.002 cubic metres (2 litres)

### Working Pressure

Refer to meter index badge

### Index Drive

Magnetically driven index ensuring low mechanical wear.

### Index

Anti-Fog hydrophilic coated 8 digit index 5 whole cubic metres (white numbers on black wheels) and 3 decimal places (white numbers on red wheels).

### Threads

Meter boss threads vertical inlet/outlet 10 Light 1" to BS746 1987 at 152mm (6") centres. 1" 10 Lt. to 3/4" BSP Cap Nut and Liner set available (part number SK5).

### Case Construction

Pressure die cast aluminium. Weight 2.80 kg

### Pulse Output Ready

All meters are fitted with a magnet in the far right index wheel and hence each meter is pulse retro fittable in the field 1 pulse / 10 lts.

### Corrosion Protection

Alodine internal and external pre-treatment of castings followed by baked Woodland Grey polyester powder coat for maximum corrosion protection.

### Pulse Output Module

10 litres per pulse using IN-Z61 or IN-Z62 pulse module.

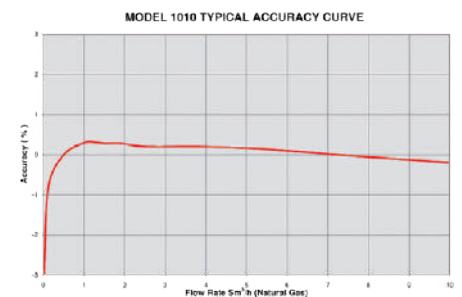

\* Continuing product improvement is Landis+Gyr policy, specifications are subject to change without notice.

# Model 1010

Ideal for Upgrading Domestic Services

## Product features:

BK-G6 Module

Capacity 10 m<sup>3</sup>/h(Gas) at 125 Pascal Loss

Low Pressure Drop

Powder coated aluminium case

Pulse Ready

Magnetically Driven, All Weather, Sealed Index

Designed to EN1359 & AG702

Optional Top Read Index

Optional Viton O-rings

Noise Reduced Valve Table



## Model 1010 Wireframe

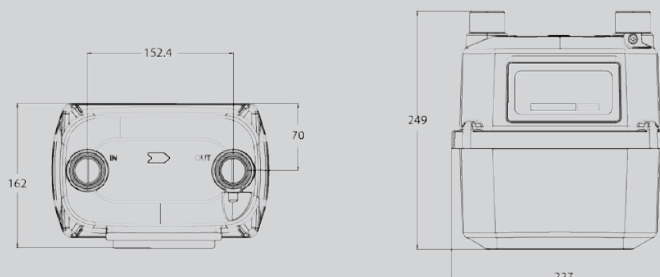

### Contacts:

Melbourne +61 3 8368 1600

Sydney +61 2 9690 7409

Brisbane +61 7 3265 4344

Perth +61 8 9244 3523

### Customer Service Toll Free

Australia 1800 337 957

### New Zealand

Auckland +64 9 579 1155

[www.landisgyr.com](http://www.landisgyr.com)